

1 | Ø 92

4178.10	4 Cyl.	7,0:1	┌┐ 92	2445cc	68 kW (92 HP)	Benzin
420.10	4 Cyl.	8,2:1	┌┐ 92	2445cc	75 kW (102 HP)	Benzin

53-1004015-24

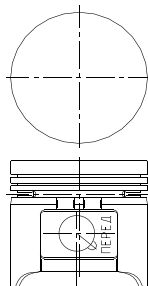

H=51,0
L=92,0

402.1000100



2,0 CR, P
2,0 P
5,0 CR, P

21-1002020-53

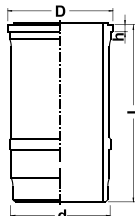

WH
D=112,5
d=100,0
h=5,0
L=170,0

21-1004020-14

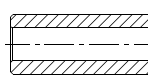

D=25,0
L=66,0

BK-21-1000105-A4



BK-21-1000110



21-1004022-01 x2



2 | Ø 96,5

A274 (EvoTech)	4 Cyl.	10,0:1	┌┐ 92	2691cc	78,5 kW (106,8 HP)	Benzin
-----------------------	--------	--------	-------	--------	--------------------	--------

A274.1004015 (STD)
A274.1004015-AP (0.50)

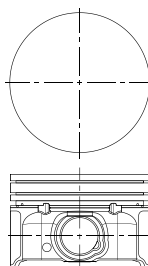

H=43,2
L=66,0

A274.1004024 (STD)
A274.1004024-AP (0.50)

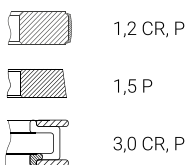

1,2 CR, P
1,5 P
3,0 CR, P

A274.1004020

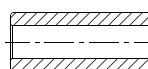

D=25,0
L=62,0

A274.1004018 (STD)
A274.1004018 (0.50)



21-1004022-01 x2



3 | Ø 100

4218.10	4 Cyl.	7,0:1	┌┐ 92	2890cc	67 kW (89HP)	Benzin
4213.10	4 Cyl.	8,2:1	┌┐ 92	2890cc	72 kW (98HP)	Benzin

421.1004015 (STD)
421.1004015-P3 (0.50)
421.1004015-P5 (1.00)

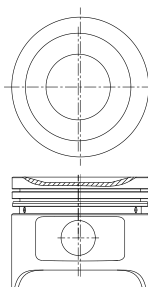

H=43,5
B=-4,0
BØ=77,0
L=80,0

421.1004024 (STD)
421.1004024-P1 (0.50)
421.1004024-P5 (1.00)

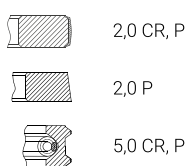

2,0 CR, P
2,0 P
5,0 CR, P

421.1004020-01

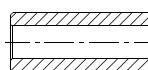

D=25,0
L=66,0

421.1004018 (STD)
421.1004018-P (0.50)
421.1004018-P5 (1.00)



21-1004022-01 x2



4216 (всех модиф.)

4 Cyl.

8,8:1

□ 92

2890cc

90 kW (123 HP)

Benzin

421.1004015-23 (STD)
421.1004015-23-P3 (0.50)
421.1004015-23-P5 (1.00)

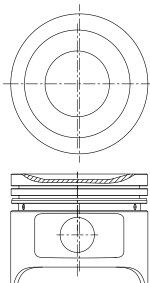

H=43,5
B=-1,35
BØ=77,0
L=80,0

421.1004024 (STD)
421.1004024-P1 (0.50)
421.1004024-P5 (1.00)

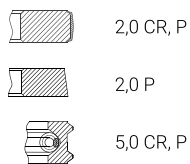

421.1004020-01

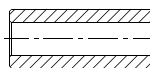

D=25,0
L=66,0

21-1004022-01 x2



421.1004018-23 (STD)
421.100 4018-23-P (0.50)
421.1004018-23-P5 (1.00)



421.1004024-10 (STD)

