

	РАБОЧИЙ ОБЪЕМ			ПОРЯДКОВЫЙ НОМЕР
СМД-14БН	Diesel	6300	4	120	3
СМД-14Н	Diesel	6300	4	120	3
СМД-15Н	Diesel	6300	4	120	3
СМД-17КН	TurboDiesel	6300	4	120	1
СМД-17Н	TurboDiesel	6300	4	120	2
СМД-18Н	TurboDiesel	6300	4	120	2
СМД-18НП	TurboDiesel	6300	4	120	2
СМД-19	TurboDiesel	6300	4	120	1
СМД-20	TurboDiesel	6300	4	120	1
СМД-21	TurboDiesel	6300	4	120	2
СМД-22	TurboDiesel	6300	4	120	2
СМД-22А	TurboDiesel	6300	4	120	2
СМД-60	TurboDiesel	9150	V6	130	4
СМД-61	TurboDiesel	9150	V6	130	4
СМД-62	TurboDiesel	9150	V6	130	4
СМД-63	TurboDiesel	9150	V6	130	4
СМД-64	TurboDiesel	9150	V6	130	4
СМД-65	TurboDiesel	9150	V6	130	4
СМД-66	TurboDiesel	9150	V6	130	4
СМД-72	TurboDiesel	9150	V6	130	4
СМД-73	TurboDiesel	9150	V6	130	4

1 | Ø 120

СМД-14Н	4 Cyl.	16:1	┌┐ 140	6300cc	61 kW (83 HP)	Diesel
СМД-14БН	4 Cyl.	16:1	┌┐ 140	6300cc	61 kW (83 HP)	Diesel
СМД-15Н	4 Cyl.	16:1	┌┐ 140	6300cc	61 kW (83 HP)	Diesel
СМД-17КН	4 Cyl.	16:1	┌┐ 140	6300cc	74 kW (100 HP)	TurboDiesel
СМД-19	4 Cyl.	16:1	┌┐ 140	6300cc	88 kW (120 HP)	TurboDiesel
СМД-20	4 Cyl.	16:1	┌┐ 140	6300cc	88 kW (120 HP)	TurboDiesel

20-0305A-11

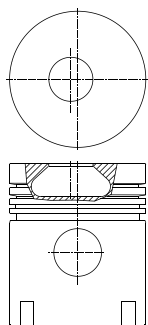

H=78,5
B=-29,3
BØ=38,8
L=143,0

20-03c6-11

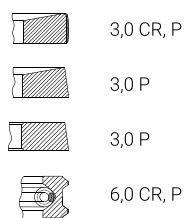

14-0102-01

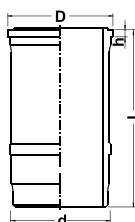

WH
D=142,0
h=10,2
d=133,0
L=263,0

СМД9-0128 x1
14-0141 x1

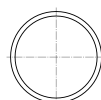

СМД9-0306-1A

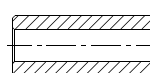

D=42,0
L=102,0

J42x1,75 DIN 472 x2



20-03c8



20-03c5



20-01c15



20-0305AП

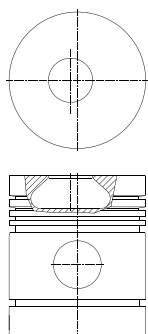

H=78,5
B=-29,3
BØ=38,8
L=143,0

20-03c6-A5

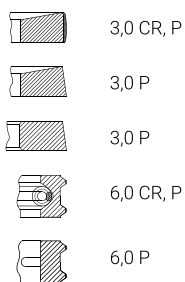

20-01c15-K5



2 | Ø 120

СМД-17Н	4 Cyl.	16:1	┌┐ 140	6300cc	74 kW (100 HP)	TurboDiesel
СМД-18Н	4 Cyl.	15,5:1	┌┐ 140	6300cc	74 kW (100 HP)	TurboDiesel
СМД-18НП	4 Cyl.	16:1	┌┐ 140	6300cc	74 kW (100 HP)	TurboDiesel
СМД-21	4 Cyl.	16:1	┌┐ 140	6300cc	107 kW (145 HP)	TurboDiesel
СМД-22	4 Cyl.	16:1	┌┐ 140	6300cc	107 kW (145 HP)	TurboDiesel
СМД-22А	4 Cyl.	16:1	┌┐ 140	6300cc	107 kW (145 HP)	TurboDiesel

22-0305A-11

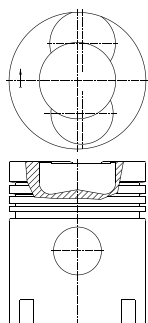

H=78,5
B=-28,7
BØ=67,0
e1=1,5
e2=1,5
L=143,0

20-03c6-11

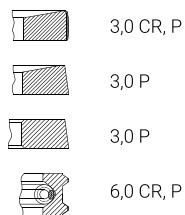

14-0102-01

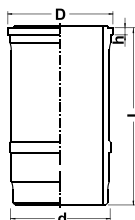

WH
D=142,0
h=10,2
d=133,0
L=263,0

СМД9-0306-1А

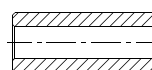

D=42,0
L=102,0

J42x1,75 DIN 472 x2



СМД9-0128 x1
14-0141 x1

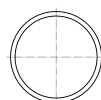

22-03c8



22-03c5



22-01c15



3 | Ø 120

СМД-14Н	4 Cyl.	16:1	┌┐ 140	6300cc	61 kW (83 HP)	Diesel
СМД-14БН	4 Cyl.	16:1	┌┐ 140	6300cc	61 kW (83 HP)	Diesel
СМД-15Н	4 Cyl.	16:1	┌┐ 140	6300cc	61 kW (83 HP)	Diesel

14Н-0305АП

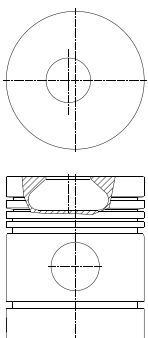

H=78,5
B=-28,5
BØ=38,8
L=143,0

14-03c6-A5

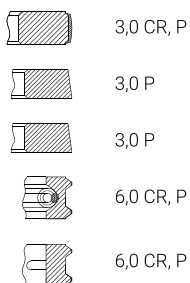

14-0102-01

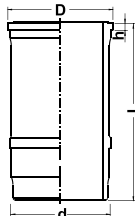

WH
D=142,0
h=10,2
d=133,0
L=263,0

СМД9-0306-1А

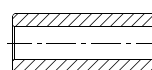

D=42,0
L=102,0

J42x1,75 DIN 472 x2



СМД9-0128 x1
14-0141 x1

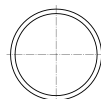

14-01c15-K5



4 | Ø 130

СМД-60	V6 Cyl.	15:1	┌┐ 115	9150cc	117 kW (160 HP)	TurboDiesel
СМД-61	V6 Cyl.	15:1	┌┐ 115	9150cc	117 kW (160 HP)	TurboDiesel
СМД-62	V6 Cyl.	15:1	┌┐ 115	9150cc	128 kW (175 HP)	TurboDiesel
СМД-63	V6 Cyl.	15:1	┌┐ 115	9150cc	128 kW (175 HP)	TurboDiesel
СМД-64	V6 Cyl.	15:1	┌┐ 115	9150cc	117 kW (160 HP)	TurboDiesel
СМД-65	V6 Cyl.	15:1	┌┐ 115	9150cc	117 kW (160 HP)	TurboDiesel
СМД-66	V6 Cyl.	15:1	┌┐ 115	9150cc	132 kW (180 HP)	TurboDiesel
СМД-72	V6 Cyl.	15:1	┌┐ 115	9150cc	158 kW (215 HP)	TurboDiesel
СМД-73	V6 Cyl.	15:1	┌┐ 115	9150cc	158 kW (215 HP)	TurboDiesel

60-03105.31A

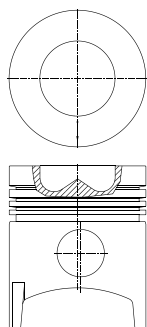

AK

H=83,0
B=-24,6
BØ=71,5
L=155,0

236-1004002-A4

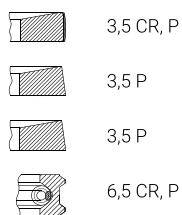

3,5 CR, P
3,5 P
3,5 P
6,5 CR, P

60-01102-12

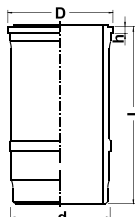

WH

D=160,0
h=12,13
d=151
L=223,0

СМД9-0128 x2

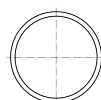

60-03106.00

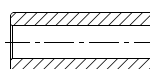

D=45,0
L=110,0

740.1004022 x2



60-01c15

