

		РАБОЧИЙ ОБЪЕМ			ПОРЯДКОВЫЙ НОМЕР
B-Series 3.9	TurboDiesel	3920	4	102	3
B-Series 5.9	TurboDiesel	5890	6	102	3
ISBe 4.5	TurboDiesel	4460	4	107	4
ISBe 6.7	TurboDiesel	6690	6	107	4
ISF2.8	TurboDiesel	2781	4	94	1
ISF3.8	TurboDiesel	3760	4	102	2
6CT/CTA	TurboDiesel	8270	6	114	5
ISLe 8.9	TurboDiesel	8880	6	114	5
L-Series 8.9	TurboDiesel	8880	6	114	5

1 | Ø 94

ISF2.8	4 Cyl.	16,5:1	┌┐ 100	2781cc	88kW (120 HP)	TurboDiesel
---------------	--------	--------	--------	--------	---------------	-------------

ISF2.8-1004015
(44 14 15 01 0)

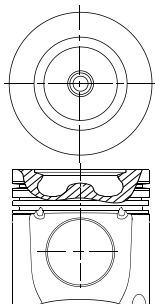

KK, AK,
RT
H=48,6
B=-16,2
BØ=52,0
L=76,0

44 14 30 01 000 (STD)
44 14 30 01 050 (0,5)

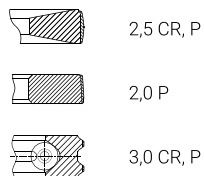

44 14 21 02 8

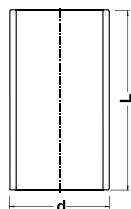

d=98,0
L=190,0

ISF2.8-1004020



D=34,5
L=73,0

ISF2.8-1004022 x2



ISF2.8-1004018 (STD)
ISF2.8-1004018-AP (0,5)



2 | Ø 102

ISF3.8	4 Cyl.	17,2:1	┌┐ 115	3760cc	112kW (152 HP)	TurboDiesel
---------------	--------	--------	--------	--------	----------------	-------------

ISF3.8-1004015

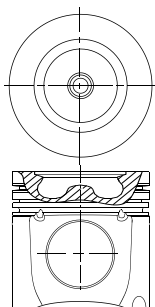

KK, AK,
RT
H=74,0
B=-17,5
BØ=54,5
L=109,0

ISF3.8-1000100

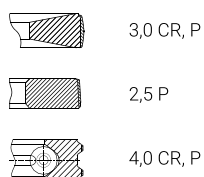

44 14 21 03 8

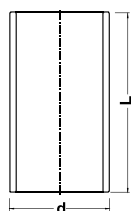

d=104,56
L=200,0

ISF3.8-1004020

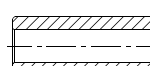

D=40,0
L=83,0

J40x1,75 DIN472 x2



ISF3.8-1004018



3 | Ø 102

B-Series 3.9	4 Cyl.	17,3:1	┌┐ 120	3920cc		TurboDiesel
B-Series 5.9	6 Cyl.	17,3:1	┌┐ 120	5890cc		TurboDiesel

EQB-1004015

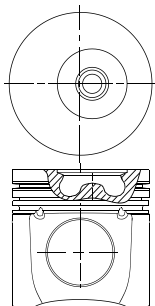

RT
H=71,6
B=-22,1
BØ=51,3
L=105,6

EQB-1000106

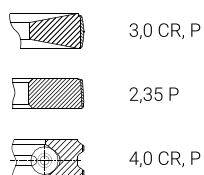

44 14 21 03 8

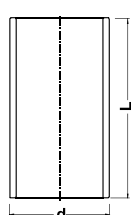

d=104,56
L=200,0

EQB-1004020

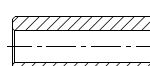

D=40,0
L=83,0

J40x1,75 DIN472 x2



EQB-1000128



4 | Ø 107

ISBe 4.5	4 Cyl.	17,3:1	┌┐ 124	4460cc	TurboDiesel
ISBe 6.7	6 Cyl.	17,3:1	┌┐ 124	6690cc	TurboDiesel

ISBe-1004015

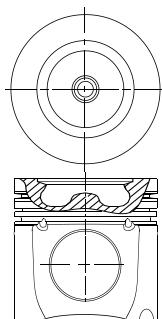

KK, AK,
RT
H=69,4
B=-18,3
BØ=61,0
L=103,2

44 14 30 02 000 (STD)
44 14 30 02 050 (0,5)

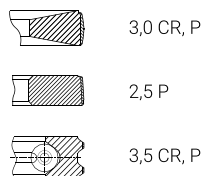

44 14 21 04 8

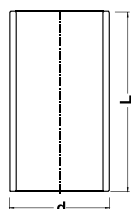

d=109,5
L=205,0

ISBe-1004020

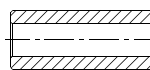

D=40,0
L=90,5

J40x1,5 DIN472 x2



ISBe-1000128 (STD)
ISBe-1000128-AP (0,5)



5 | Ø 114

6CT/CTA	6 Cyl.	16,6:1	┌┐ 135	8270cc	TurboDiesel
L-Series 8.9	6 Cyl.	16,6:1	┌┐ 145	8880cc	TurboDiesel
ISLe 8.9	6 Cyl.	16,6:1	┌┐ 145	8880cc	TurboDiesel

L-1004015 (44 14 15 09 0)

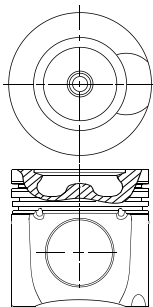

KK, AK,
RT
H=74,5
B=-22,0
BØ=64,8
e=1,0
L=110,5

ISLe-1000106

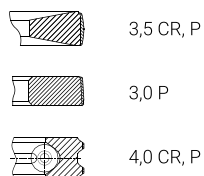

ISLe-1002021
(44 14 21 01 0)

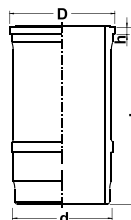

WH
D=130,95
H=123,04
f=1,25
d=125,68
L=235,5

ISLe-1004020

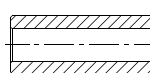

D=45,0
L=91,0

J45x1,75 DIN472 x2



L-1000128



ISLe-1004015

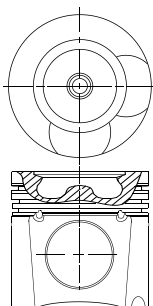

KK, AK,
RT
H=74,3
B=-22,0
BØ=64,8
e=1,0
L=110,5

ISLe-1002023 x1

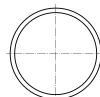

ISLe-1000128

